

Technical Information

# PURe<sup>®</sup> parallel window system

**PURe<sup>®</sup>**  
WINDOW SYSTEMS

## Scope

The PURe® parallel window has been designed to meet current and future building regulations, with impressive U values and thermal performances. PURe® is an evolved generation of aluminium window systems manufactured in the UK. It combines the long life and low maintenance of aluminium externally with a patented high insulation PUR foam thermal barrier. PURe® parallel windows are capable of accepting glazing up to 57mm thick depending on weight.

## Materials

- All aluminium sections are extruded using Aluminium Alloy 6060 or 6063 T6 to BS EN 755 part 9 2008 or BS EN 12020-2.
- Polyamide thermal barriers are manufactured in accordance with PA66 GF25.
- Gaskets are manufactured in accordance with BS3734.

## Finishes

PURe® parallel window sections are available typically in two finishes.

- Polyester Powder Coating to BS EN 12206-1: 2004 Part 1 – painted in house. Surface finish at 40 microns standard, or enhanced to 60 microns for marine environments, in accordance with ISO 9001, ISO 14001 and ISO 18001.
- Anodised finishes are to BS3897:1991 to a minimum of 25 microns (AA25), supplied in either satin or polished finish in a limited range of colours.

## Construction

PURe® is constructed using mitred corners, joined with crimped cleats; alignment chevrons assist in clean, accurate mitres. Integral transoms and mullions are scribed around the outer frames and fixed with either screw ports or shear blocks.

A proprietary sealant is used on all metal joints in line with good practice.

Opening window frames are designed to be inserted directly into the outer frames using butt hinges or tilt/turn mechanism.

**Specification. Please contact our national team of architectural advisors for advice on product suitability, calculations and NBS or bespoke specifications.**

## Typical sizes

	Width (mm)		Height (mm)
Pure® parallel	1500	x	2400

\*For guidance only – when exceeded please consult our technical department

## Weather Rating

BS5375 - 1

Air Permeability	600Pa
Water Tightness	600Pa
Wind Resistance	2400Pa

## Glazing Thickness

Radius Vent	28 - 48mm
Flat Faced Vent	28 - 57mm

For thicker options please consult our technical department



## Testing



Tested to PAS24, BS5375 - 1, BS5375 - 2, BS5375 - 3 Annex A

## Patent Number

GB252363.8

## Average U values

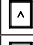
Residential CEN standard	1230 x 1480
 28mm Double Glazed Unit	1.33 W/m²K
 48mm Triple Glazed Unit	0.97 W/m²K

Commercial CEN standard	1230 x 1480
 28mm Double Glazed Unit	1.27 W/m²K
 48mm Triple Glazed Unit	0.90 W/m²K

For glazing specification please contact our technical department

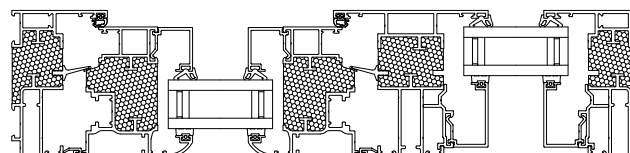

Radius vent

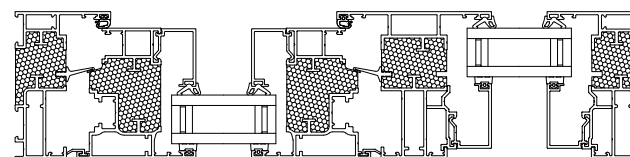

Flat faced vent

## Environmental

Senior Architectural Systems is fully compliant with BS EN ISO 9001, BS EN ISO 14001, OHSAS 18001 standards and BES 6001.

PURe®, when used on projects involved in a BREEAM assessment, or within the Code for a Sustainable Built Environment and the Code for Sustainable Homes (which therefore involves the Green Guide to specification) can offer significant benefits. For project specific assistance, please contact our specification team.

Senior Architectural Systems Ltd, Eland Road, Denaby Main, Doncaster, South Yorkshire, DN12 4HA.

Tel: 01709 772 600 E-mail: [info@sasmail.co.uk](mailto:info@sasmail.co.uk) [www.seniorarchitectural.co.uk](http://www.seniorarchitectural.co.uk)

Due to a policy of continual product development, Senior Architectural Systems Ltd reserves the right to alter any of the specifications given in this publication without prior notice. The specification for any given application must be checked with Senior Architectural Systems Ltd prior to manufacture. No responsibility for accuracy is accepted by Senior Architectural Systems Ltd.