

Technical information

# PURE<sup>®</sup> casement window system

**PURE<sup>®</sup>**  
WINDOW SYSTEMS

## Scope

The PURE® casement window has been designed to meet current and future building regulation, with impressive U values and thermal performances. PURE® is an evolved generation of aluminium window systems manufactured in the UK. It combines the long life and low maintenance of aluminium externally with a patented high insulation PUR foam thermal barrier. PURE® casement windows are capable of accepting glazing up to 50mm thick depending on weight.

## Materials

- All aluminium sections are extruded using Aluminium Alloy 6060 or 6063 T6 to BS EN 755 part 9 2008 or BS EN 12020-2.
- Polyamide thermal barriers are manufactured in accordance with PA66 GF25.
- Gaskets are manufactured in accordance with BS3734.

## Finishes

PURE® casement window sections are available typically in two finishes.

- Polyester Powder Coating to BS EN 12206-1: 2004 Part 1 – painted in house. Surface finish at 40 microns standard, or enhanced to 60 microns for marine environments, in accordance with ISO 9001, ISO 14001 and ISO 18001.
- Anodised finishes are to BS3897:1991 to a minimum of 25 microns (AA25), supplied in either satin or polished finish in a limited range of colours.

## Construction

PURE® is constructed using mitred corners, joined with crimped or mechanical cleats; alignment chevrons assist in clean, accurate mitres. Integral transoms and mullions are scribed around the outer frames and fixed with either screw ports or shear blocks.

A proprietary sealant is used on all metal joints in line with good practice. Opening window frames are designed to be inserted directly into the outer frames using friction stays

## Typical\* sizes

	Width (mm)		Height (mm)
PURE® Casement	1500	x	1500

\*For guidance only – when exceeded please consult our technical department

## Weather Rating BS6375 part 1

Air Permeability	600 Pa
Water Tightness	600 Pa
Wind Resistance	2400 Pa

## Glazing

Thickness	28mm - 50mm
-----------	-------------





For thicker options please consult our technical department

## Testing

Tested to PAS24, BS6375-2 and BS6375-3
--

## Patent Pending Number 1500459.1

## Average U values

Residential CEN standard		1230 x 1480
	28mm Double Glazed Unit	1.24 W/m²K
	48mm Triple Glazed Unit	0.76 W/m²K
Commercial CEN standard		1230 x 1480
	28mm Double Glazed Unit	1.19 W/m²K
	48mm Triple Glazed Unit	0.73 W/m²K

For glazing specification please contact our technical department

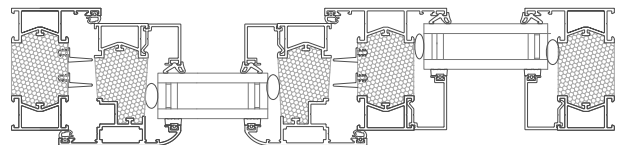

## Environmental

Senior Architectural Systems is fully compliant with BS EN ISO 9001, BS EN ISO 14001 and OHSAS 18001 standards.

PURE®, when used on projects involved in a BREEAM assessment, or within the Code for a Sustainable Built Environment and the Code for Sustainable Homes (which therefore involves the Green Guide to specification) can offer significant benefits. For project specific assistance, please contact our specification team.

**Specification. Please contact our national team of architectural advisors for advice on product suitability, calculations and NBS or bespoke specifications.**