



PUR^e® Commercial Door System

Technical Datasheet

Scope

The PUR^e® commercial door system has been designed to meet current and future building regulations, with impressive U-values and thermal performances. PUR^e® is an evolved generation of aluminium window and door systems manufactured in the UK. It combines the long life and low maintenance of aluminium with a patented high insulation PUR foam thermal barrier. PUR^e® commercial doors are capable of accepting glazing up to 60mm thick.

Materials

- Extruded aluminium is generally Aluminium Alloy 6060.T6/T66, 6063.T6/T66, 6082.T6 to BS EN 755-9 and EN 12020-2.
- Polyamide thermal barriers are manufactured in accordance with PA66 GF25.
- The Gasketry is generally manufactured in accordance with BS ISO 3302-1.
- The fixings are generally A2 Stainless Steel screws.

Finishes

PUR^e® Commercial door sections are available typically in two finishes.

- Polyester Powder Coating to BS EN 12206-1 Part 1 painted in house. Surface finished to a minimum of 40 microns standard, or enhanced to suit project requirements, in accordance with ISO 9001, ISO 14001 and ISO 45001.
- Anodised finishes are to BS3897 to a minimum of 25 microns (AA25), supplied in either satin or polished finish in a limited range of colours.

Construction

PUR^e® is constructed using mitred corners and/or shear blocks, joined with crimped or mechanical cleats; alignment chevrons assist in clean, accurate mitres. A proprietary sealant is used on all metal joints in line with good practice. Automatic solutions are also available.

Environmental

Senior Architectural Systems is fully compliant with BS EN ISO 9001, BS EN ISO 14001, ISO 45001 and BES6001 standards. When used on projects involved in a BREEAM assessment, or within the Code for a Sustainable Built Environment, (which therefore involves the Green Guide specification) can offer significant benefits. For project specific assistance, please contact our specification team.

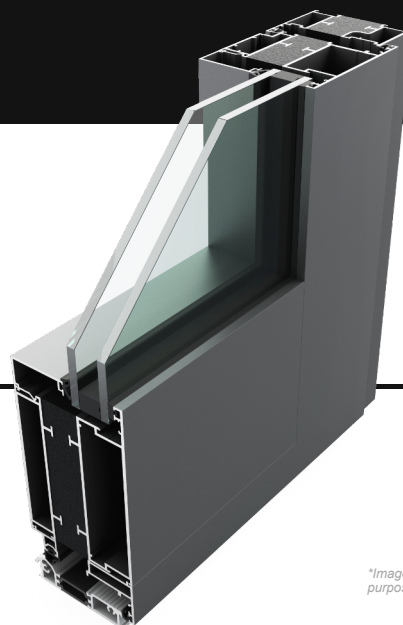

**Image for indicative purposes only*

Typical Sizes

Standard	
Max door leaf width	1400mm
Max door leaf height	3000mm
Max weight per door leaf	180kg

Electronic Locking

Max door leaf width	1400mm
Max door leaf height	2500mm
Max weight per door leaf	180kg

Panic Exit

Max door leaf width	1350mm
Max door leaf height	2500mm
Max weight per door leaf	180kg

*Average U-values

Single Door	
CEN standard (Double Glazed)	1.3 W/m ² K
CEN standard (Triple Glazed)	0.94 W/m ² K
Double Door	
CEN standard (Double Glazed)	1.3 W/m ² K
CEN standard (Triple Glazed)	0.89 W/m ² K

Glazing

Thickness	28mm - 60mm
-----------	-------------

Testing

Security	PAS24 & SBD
**BS6375 - 1	✓
BS6375 - 2	✓

Acoustics

Acoustics performance (IGU Dependent)	38dB reduction is achievable
---------------------------------------	------------------------------

*All calculations are based on CEN sized single doors 1230mm x 2180mm ±25% and double door 2000mm x 2180mm ±25%.

**Results may vary based on specification. Further details are available upon request.

Test certifications available upon request.

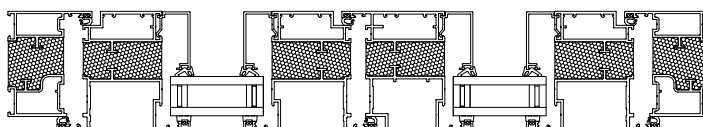

Secured by Design



Official Police Security Initiative



Senior Architectural Systems Ltd, Eland Road, Denaby Main, Doncaster, South Yorkshire, DN12 4HA.
Tel: 01709 772 600 E-mail: info@sasmail.co.uk www.seniorarchitectural.co.uk

Due to a policy of continual product development, Senior Architectural Systems reserves the right to alter any of the specifications given in this publication without prior notice. The specification for any given application must be checked with Senior Architectural Systems prior to manufacture. No responsibility for accuracy is accepted by Senior Architectural Systems. Always refer to the Technical Manual.

